

# Luxury Yacht Deck Plans

## Emerald Kaia

- DECK 7 SKY DECK
- DECK 6 POOL DECK
- DECK 5 PANORAMA DECK
- DECK 4 OBSERVATION DECK
- DECK 3 EMERALD DECK
- DECK 2 WELLNESS DECK

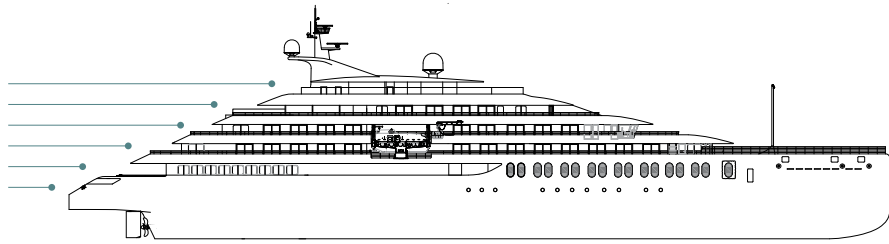

**Deck 7  
Sky Deck**

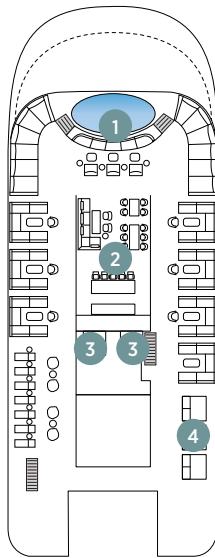

**Deck 6  
Pool Deck**

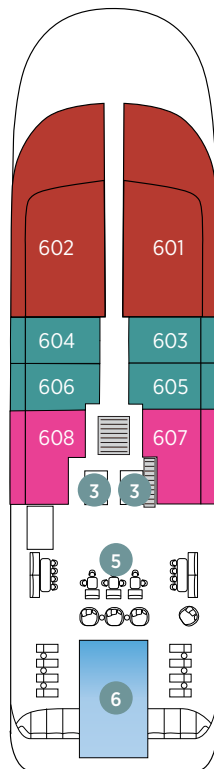

**Deck 5  
Panorama Deck**

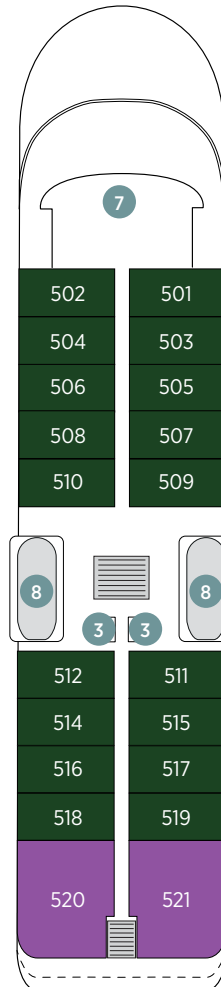

**Deck 4  
Observation Deck**



*Indoor/Outdoor Gym (artist's impression)*



Spa Pool & Sky Bar (artist's impression)

### Deck 3 Emerald Deck

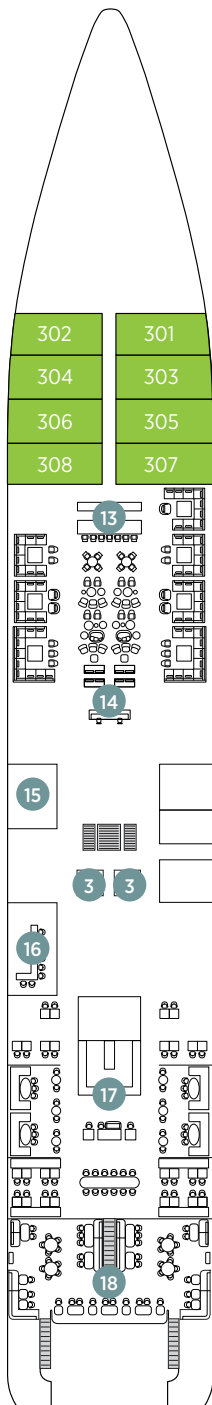

### Deck 2 Wellness Deck

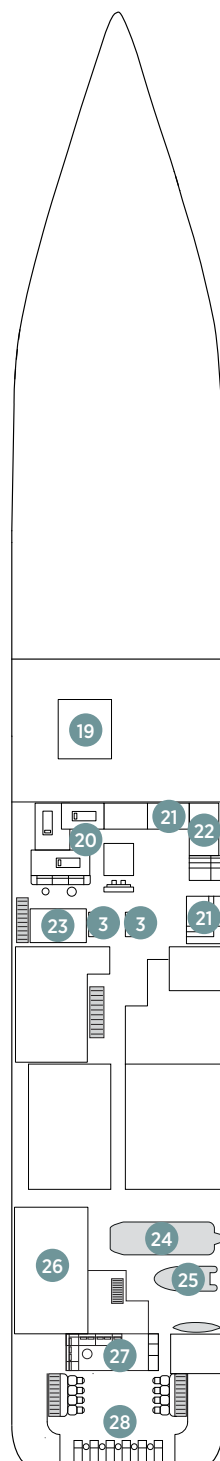

- Launching 2026
- Length: 120m (393.7ft)
- Guests: 128
- Cabins: 64
- Crew Members: 92

- 1 Spa Pool
- 2 Sky Bar
- 3 Lifts
- 4 Sky Deck Cabanas
- 5 Aqua Café
- 6 Aqua Pool
- 7 Navigation Bridge
- 8 Life Boats
- 9 Spa Pool
- 10 Observation Sun Deck
- 11 Observation Lounge
- 12 Self-Service Laundry
- 13 Amici Bar & Lounge
- 14 Reception
- 15 Boutique
- 16 Night Market Grill
- 17 La Cucina Dining
- 18 La Cucina Terrace
- 19 Medical Centre
- 20 Elements Spa
- 21 Sauna
- 22 Infrared Sauna
- 23 Hairdresser
- 24 Tender Boat
- 25 Zodiacs
- 26 Gym
- 27 Marina Lounge
- 28 Marina Deck

### Cabin Categories

Pool Deck – 6		Size (m <sup>2</sup> )
SA	Owner's Suite	130.8m <sup>2</sup>
S	Deluxe Balcony Suite	44.3m <sup>2</sup>
AB	Balcony Suite	31.6m <sup>2</sup>
Panorama Deck – 5		Size (m <sup>2</sup> )
T	Terrace Suite	77.2m <sup>2</sup>
A	Balcony Suite	31.6m <sup>2</sup>
Observation Deck – 4		Size (m <sup>2</sup> )
Y	Yacht Suite	81.7m <sup>2</sup>
B	Balcony Suite	31.6m <sup>2</sup>
Emerald Deck – 3		Size (m <sup>2</sup> )
D	Oceanview Stateroom	20.6m <sup>2</sup> – 23.2m <sup>2</sup>

Interconnecting Suites are available - enquire for details

**Important Information:** Deck plans are an indication only and are subject to variation. Cabin sizes include terrace areas.