

THE SCENIC GROUP

Charters, Meetings & Incentive Groups

OCEAN & YACHT CRUISING



Ultra Luxury Discovery Voyages



Luxury superyacht cruising

For more information contact our **Group and Charters Team** on charters@scenic.eu
Visit scenic.eu/charter | Visit emeraldcruses.eu/charter

WELCOME

As part of the Scenic Group, both Scenic Luxury Cruises & Tours and Emerald Cruises are well versed in the art of luxury ocean cruising. What we don't know isn't worth knowing and, between us, we believe we have exactly what it takes to create the perfect ocean cruising experience for your guests.

Combining innovative design, world-class facilities and state-of-the-art technology, Scenic Eclipse sets the benchmark in 6-star cruising. Unrivalled worldwide discovery in truly all-inclusive ultra-luxury, exceptional once-in-a-lifetime experiences and a world-class crew await on board The World's First Discovery Yachts. Be immersed in the extraordinary during exceptional onshore experiences, led by an expert Discovery Team, and indulge on board with luxuriously appointed suites, the spacious 550m² Senses Spa, and up to 10 exceptional dining experiences. This is where ultra-luxury meets discovery.

Emerald Cruises are the small ship experts, brining their award-winning reputation to the world's most beautiful coastlines on board spectacular superyachts. With the unique capability to dock in the smaller ports of the Mediterranean, the Adriatic Sea, the Red Sea and the Black Sea, an intimate 100-guest capacity will allow your group to delight in an abundance of space, while enjoying unparalleled on board facilities.



SCENIC ECLIPSE

Scenic Eclipse, Antarctica

Inspired by the sleek contours of a sailing yacht, Scenic Eclipse, The World's First Discovery YachtSM, is the benchmark in ultra-luxury cruising.

Equipped with an on-board submersible¹, two helicopters², a fleet of Zodiacs and a specialist Discovery Team of up to 20, Scenic Eclipse offers the opportunity for unrivalled worldwide exploration.

We invite your guests to travel on board Scenic Eclipse, where an almost 1:1 staff-to-guest ratio and a maximum of 228 guests³ at any time, ensures their experience will be one of truly all-inclusive indulgence. Each aspect of their comfort and peace-of-mind has been considered as our highly trained staff anticipates their every need. They'll have a personal butler service, the choice of up to 10 dining experiences – inspired by all four corners of the globe – and unlimited complimentary beverages, all at no extra cost⁴.

¹Weather and sea conditions in addition to crew subject to regulatory approval. ²Weather, weight restrictions and medical approval are required and are subject to a 20% guests on port charges.



EMERALD CRUISES

Emerald Azura, Dubrovnik

Emerald Cruises yacht cruises provide a luxury, intimate yacht cruising experience along the world's most celebrated coastlines. Every one of our carefully crafted itineraries provides the perfect platform for new experiences, and our collection of included excursions introduce a wealth of culture, bringing these fascinating destinations to life.

Your guests will follow a day of exploration delighting in the stylish surrounds of our superyachts, which has been custom designed to venture directly into the fascinating ports and harbours only accessible to smaller yachts. Across six beautifully appointed decks, they will experience the finest service and enjoy a host of deluxe amenities such as a stunning infinity-style Aqua Pool, a sunning platform, perfect for swim stops and, of course an impressive collection of suites, restaurants and dining venues.



Contents

	Page
The Small Ship Experience	4-5
Benefits of Group Travel	6
Chartering Opportunities	7
Scenic Eclipse - Truly All-Inclusive Luxury	8-9
The On Board Experience - Scenic Eclipse	10-11
The Onshore Experience - Scenic Eclipse	12-13
On Board Inclusions - Emerald Cruises Yacht Cruising	14-15
The On Board Experience - Emerald Cruises Yacht Cruising	16-17
The Onshore Experience - Emerald Cruises Yacht Cruising	18-19
Our Destinations - Scenic Eclipse	20-21
Our Destinations - Emerald Cruises Yacht Cruising	22-23
Meet the Fleet - Scenic Eclipse	24-27
Meet the Fleet - Emerald Cruises Yacht Cruising	28-31



CHARTERING EXPERIENCES

If your goal is to create an experience that is truly special, then chartering a yacht is the solution.

We believe that our yachts are the finest venues for any event and when you charter with Scenic Group you can guarantee full flexibility to travel your way.

We take care of every detail so that you can focus on what's important - creating incredible memories that you'll remember for a lifetime.



On board submarine, Scenic Neptune



Celebrate in style



Emerald Superyachts, Marina Platform



Scenic Eclipse, Helicopter

Getting Started

From the time of initial contact and quote to the post cruise follow up, you'll have one main point of contact who will assist you in making this the best trip possible.

Charter rates quoted include all the standard offerings of any standard cruise (including port taxes/fees) and reflect the lowest offered rates. A 10% deposit is required up front, followed by three incremental payments, with payment due in full a minimum of 90 days in advance of departure.

Your charter offers full exclusivity as it is 'your' vessel for the duration of the sailing.

Customise your cruise

We offer an extensive selection of ways to personalise your charter, including:

- Corporate personalisation and branding on board
- Complimentary use of meeting spaces, including A/V set up
- Onshore excursion programmes, including Scenic Freechoice, Scenic Enrich, EmeraldPLUS and EmeraldACTIVE
- Bespoke shore excursions and onshore events
- Meal requests and menu modifications including Kosher
- Gala dinners and cocktail parties on board
- Amended ports of call and new destinations

- Use of helicopters and submarines (Scenic Eclipse)
- Expert Discovery Team for expedition voyages (Scenic Eclipse)
- An Activity Manager for Pilates, aqua aerobics and more (Emerald Cruises)

Kosher options available on board Emerald Cruises Superyachts only and are subject to approval.



— MEETING, INCENTIVES, CONFERENCES AND EVENTS

Incentive Trips and Conferences

Let us arrange a personalised business conference with complimentary use of meeting spaces and A/V set up. Or reward high sales earners on incentive trips, including themed gala dinners onshore in exclusive locations.

Choose Scenic Group for:

- Unique, once-in-a-lifetime experiences
- Corporate branding and personalisation options
- Complimentary use of meeting spaces including A/V set up



Incentive Groups

For Incentive groups that do not need the exclusivity of an entire ship, we offer an Incentive group programme.

- Minimum group size to qualify as an incentive group = 10 staterooms
- Maximum allowed group size = 50% of ship capacity
- Discounted incentive group rates are offered by category and include all the standard inclusions
- Earn complimentary tour conductor staterooms (1 double for 10 paid - maximum 2 doubles earned)
- 10% deposit up front with actual staterooms being assigned at the time of deposit and schedule of incremental deposits with final due 90 days prior to departure
- From the time of initial contact and quote to the post-cruise follow up, you'll have one contact assisting you to make this the best trip possible
- Meeting space with A/V available at no additional charge

Scenic and Emerald Cruises offer a generous site inspection policy - please call for details.



Scenic Eclipse Theatre, seats 136 pax

(MICE) —



Celebrations and Events

Celebrate in style, your way. Whether it's a birthday, anniversary or reunion, Scenic Group will make it unforgettable, with personalised parties and festivities on board and onshore in a unique venue of your choice. Just let us take care of the details.

Choose Scenic Group and enjoy:

- The freedom to customise
- Prestige and complete privacy
- Pre-arranged events and celebrations without the hassle

For Your Corporate Needs and Resale

For businesses and travel agencies looking to charter a river or ocean cruise ship, we have the luxury solution you're looking for.

Choose Scenic Group and

- Create a bespoke cruise for your target audience
- Benefit from attractive charter rates versus publicly available rates
- Enjoy the peace of mind knowing that we will pre-arrange every detail for you



"In our seven-year partnership we can only look back on optimally successful cruises. These are enhanced by the professionalism shown by all at Scenic Group - KTreks.Inc."

MEET THE FLEET - SCENIC ECLIPSE

WHERE ULTRA-LUXURY MEETS DISCOVERY



*Pilot Helicopters**

Soar above majestic fjords, glaciers & archaeological sites in one of our helicopters and discover the many wonders beyond the horizon.

Kayaks

Discover nature up-close in our tandem kayaks. Enjoy truly all-inclusive, active explorations.

Observation Deck

Spacious Observation Terrace overlooking the front of the yacht with sweeping views.

Observation Lounge

Provides optimal viewing with Swarovski telescopes and a place to relax.

State of the Art Technology

A strengthened hull, forward bow thrusters and an electronic Azipod propulsion system enable safe navigation through Antarctic waters.

Polar Class

Polar Class 6 - designed and built to the latest compromising standards for ships operating in Polar waters, for complete comfort and peace of mind.

*Helicopter use subject to additional cost, subject to regulatory approval, availability, weight restrictions, medical approval and weather and ice conditions. †Spa treatment at additional cost. NE: Some images are a bit of an impression.

Up to 10 Dining Experiences

A culinary journey awaits, with up to 10 dining experiences from casual to fine dining, including 24-hour in-suite dining.

GPS Dynamic Positioning System

This maintains the ship's location without dropping anchor on to sensitive seabeds.

Senses Spa

The exclusive Senses Spa boasts 600m² of pure indulgence and tranquility, featuring an extensive menu of luxury treatments*.



Theatre

The state-of-the-art theatre hosts lectures and education programs.

Nine Lounges & Bars

With an impressive array of indoor and outdoor spaces, no more than 228 guests and only 200 in Polar regions, there is plenty of room to relax.

Oversized Stabilisers

Custom-built stabilisers are 50% larger than other ships providing greater stability for navigating waters and disembarking for shore excursions.



Submarine

Dive below and explore the delights and mysteries of the deep on an unforgettable excursion in our submarine, Scenic Neptune.

Marina

The specially designed marina makes boarding our Zodiacs and kayaks a breeze.

Zodiacs

Our fleet of Zodiacs will take you to the heart of your destination.



— THE ON BOARD EXPERIENCE - SCENIC ECLIPSE —

The benchmark in ultra luxury cruising, taking your guests closer to the extraordinary than ever before. Experience the extraordinary in every way on board the World's First Discovery Yachts.

Welcoming just 228 guests – only 200 in the polar regions – every element of Scenic Eclipse has been carefully crafted to ensure your guests will get closer to rare and extraordinary travel experiences.

Your guests will familiarise themselves with the elegant lines, perfectly proportioned suites and expansive wellness zones of The World's First Discovery YachtsSM, where every element has been considered with their enjoyment and pleasure in mind, creating a special environment that facilitates global adventure in truly 6-star ultra-luxury.

The Scenic Eclipse deck plans help them to realise our vision for this pioneering ship and the wealth of innovative features it affords them. Marvel at the lavish proportions of our Verandah Suites, the most spacious of any ocean liner, as well as the entertainment and wellness areas, each offering something new to guarantee unforgettable days at sea. Ten dining options are sure to delight the taste buds, alongside eight sumptuous bars and lounges, encouraging them to relax, unwind and indulge during their time on board.



Koko's Asian Fusion



Relaxation Room



Scenic Whiskey Bar

Dine

Scenic Eclipse offers up to 10 truly all-inclusive world-class dining experiences ranging from relaxed café style dining to 'by invitation only' private degustation. With new menus every day that draw from over 2,500 recipes, we will take your guests on a culinary journey. Small and intimate venues abound on Scenic Eclipse, affording groups the option of privacy and space at no additional cost.

Our private dining experiences include the Night Market @ Kokos and Chef's Table for degustation dining by invitation, with each experience limited to just eight and ten guests respectively - perfect for smaller groups.

Our impressive selection of cuisines and dining venues offers a variety of choices that will satisfy everyone's palate whilst also cultivating unique dining experiences and exciting feasts for them to enjoy. Guests can also take part in our dedicated on board masterclasses at Scenic Epicure which will take them on a journey of local cuisine with our expert chefs. Enjoy premium beverages any time of the day. Choose from over 100 whiskeys, top-shelf spirits and world-class fine wines*. Savour cocktails, mocktails and specialty teas at our nine bars and lounges. Or relax over a beverage from the in suite mini-bar, which is restocked daily.

Unwind

With a spacious 550m² Senses Spa, a gym, yoga and Pilates studio, outdoor terraces and pool areas, a state-of-the-art theatre and library, there is space on board to meet your guests' every relaxation need for the ultimate Discovery Yacht experience.

At Senses Spa they can boost their energy in the Vitality lounge or relax in our tranquil spaces to revitalise after a day of discovery. The unique thermal loungers will soothe the mind while the body is gently heated and purified. Personal, one-to-one Pilates, yoga, meditation and fitness sessions are also available with our instructors for expert coaching.

We also offer the opportunity to combine adventure with relaxation. Sit back, relax and let the captain take charge whilst we take in spectacular scenes on board our helicopters*, and dive below the surface with Scenic Neptune - our on board submarine*. Imagine flying over remote fjords, icebergs and glaciers; or witnessing fascinating marine life, vibrant coral reefs and mysterious underwater ruins down below.

Led by the Discovery Team, our included kayak and stand-up paddleboard programs are what sets Scenic Eclipse's itineraries apart. Guests will feel the fresh, cool ocean breeze as they explore the calm seas and take in their breathtaking surroundings.

Retreat

Scenic Eclipse has set the standard in ultra-luxury cruising with 114 luxurious suites across five decks. Designed as an indulgent haven, each suite is incredibly spacious and filled with natural light, thanks to floor-to-ceiling sliding doors opening on to a private verandah or terrace.

Each ultra-luxury suite features Egyptian cotton linen and all the luxury amenities one would expect from a 5-star hotel, including the services of a butler who will ensure your guests have complimentary refreshments and a re-stocked mini-bar as they cater for their every need.

Every guest will also enjoy our adjustable Scenic Slumber Beds, complete with pillow menu, separate lounge areas with ambient lighting options, not forgetting the all-important 'window to the world', a private verandah for making the most of that fresh ocean air.

All prices on board are included except a small number of fine, rare and vintage wines, champagnes and spirits. *Helicopter and submarine at additional cost, subject to regulatory approval, availability, weight restrictions, medical approval and weather & ice conditions. Helicopter transfers to departures in South Georgia.



— SCENIC ECLIPSE - TRULY ALL-INCLUSIVE LUXURY —

° THE SCENIC DIFFERENCE

We want your guests to enjoy the experience of a lifetime, as we reveal the many wonders of the world's magnificent oceans and waterways from the elegant surrounds of their luxury Discovery Yacht.

When they travel on board Scenic Eclipse, they can be confident that every detail is taken care of and our highly trained on board staff will anticipate their every need. To ensure their complete peace of mind, we include airport transfers and all tipping and gratuities both on board and on shore, making their cruise a truly carefree experience.

Scenic Eclipse's expert Discovery Leaders, regional Discovery Specialists and local guides will ensure every port of call surprises and delights.



Owner's Penthouse Suite lounge



Butler, Scenic Eclipse



Tom Gotter, Corporate Chef, Scenic Eclipse

Truly all inclusive discovery on board Scenic Eclipse, The World's First Discovery Yachts.**

Each Scenic Eclipse Expedition, Discovery and Cruise Voyage itinerary is handcrafted to create memories that last a lifetime. From observing the unique wildlife of Antarctica in remote locations, to discovering the immaculate azure waters of the Mediterranean, our handcrafted experiences and specialist Discovery Team will take your group to the heart of every extraordinary destination.

Scenic Expedition Voyages

Unrivalled exploration of extraordinary lands with:

- Up to 200 guests on board to maximise landings in Antarctica and the Arctic
- Up to 20-member specialist Polar Discovery Team
- Engaging lectures and education program with on board experts
- Scenic Discovery excursions by Zodiac
- Full kayak program and stand-up paddle boarding
- Complimentary expedition parka and water bottle, plus use of special polar boots*

Scenic Discovery Voyages

The perfect blend of expedition and cruise voyages with:

- Up to 228 guests on board for a truly exclusive Discovery Voyage
- Up to 16-member specialist Discovery Team
- Engaging lectures and education program with on board experts

- Scenic Discovery excursions and shore side expedition program
- Full kayak program and stand-up paddle boarding
- Exclusive Scenic Enrich experiences
- Personalised Scenic Frochloise experiences

Scenic Cruise Voyages

Immersive on shore exploration with:

- Up to 228 guests on board for a luxurious yacht experience
- Up to 4-member specialist Discovery Team to share insights on history and culture
- Local entertainment in Scenic Eclipse's state-of-the-art theatre
- Explora by E-bike
- Full kayak program and stand-up paddle boarding
- Range of water sporting activities, from inflatable trampolines to water skiing
- Exclusive Scenic Enrich experiences
- Personalised Scenic Frochloise experiences

*Complimentary expedition parka and use of special polar boots not included on 0810 and 0810 voyages.

Truly All Inclusive Luxury

...on our ocean voyages

- Only 228 guests on board (200 in Polar regions) for a truly exclusive experience
- Spacious all-verandah luxury suite accommodation
- Butler service for every guest and an almost 1:1 staff-to-guest ratio
- Up to 10 dining experiences, from casual to fine dining
- The finest selection of included premium branded beverages, with a choice of over 100 whiskeys†
- Engaging lecture and education program with on board experts
- Dedicated Observation Lounge & Terrace for optimal viewing opportunities
- On board Swarovski Telescopes and in-suite binoculars as you never miss a moment
- Indulgent 550m² Serenity Spa†, gym, yoga and Pilates studio
- Scandinavian inspired outdoor vitality pools
- State of the art theatre for daily entertainment and education program
- Complimentary WiFi††
- The opportunity to customise to your needs
- Return airport transfers, all tipping on board and on shore

†With the exception of fine and rare whiskeys and spirits. ††Not available on all dates and features may vary. ††Conditions apply.



— THE ONSHORE EXPERIENCE - SCENIC ECLIPSE —

The Discovery Team

The Scenic Eclipse Discovery Team is at the core of each Expedition and Discovery Voyage. We have the top experts in their field, from historians and geologists, to archaeologists and photographers. They'll safely guide and educate your group every step of the way, ensuring they get the most out of each destination. From on board education sessions in the state-of-the-art theatre and guided kayak excursions and nature walks, to cruising in Zodiacs in front of enormous glaciers, the Discovery Team will share their passion for, and knowledge of, these magnificent regions.



Scenic Eclipse Discovery Team



Chan Chan ruins, Peru



Explore the calm seas by kayak



Scenic Discovery Excursions

Every one of our handcrafted Scenic Discovery excursions offers a rich insight into each destination during in-depth explorations. Our expert Discovery Team of activity guides, marine biologists, historians, geologists and specialist local guides are there to accompany guests and share their priceless knowledge. From observing the unique wildlife of Antarctica in remote locations, to exploring the calm seas surrounding the Greek island of Milos by paddle board or kayak.



Scenic Enrich

Our exclusive Scenic Enrich experiences are handpicked to add depth to your guests' discovery of the destinations we visit. They'll enjoy an equestrian flamenco show in Seville, a classical concert in Turkey's 2nd century ruins, or an immersive theatrical experience of San Francisco in the Roaring Twenties.

Affording spectacular encounters far-removed from those enjoyed by the masses, they are unique to Scenic Eclipse and are available to your guests without charge thanks to our award-winning all-inclusive service.



Scenic Freechoice

Customise each day with an extensive range of expert-led Scenic Freechoice excursions, meticulously curated to cater for different fitness levels and interests. Go on a hiking adventure along the rim of Santorini's volcanic caldera, explore the Chan Chan archaeological complex from Salaverry, or learn about the local Tingit art and their connection to history while in Wrengall. From an active to a relaxed pace, there's something for everyone.



Discovery excursion, Antarctica



Exclusive Scenic Enrich events



Windsurfing, Scenic Eclipse



OUR DESTINATIONS - SCENIC ECLIPSE

Take the Scenic Eclipse Route

From the smallest features to the most opulent of delights, every aspect of our itineraries have been handcrafted so your guests experience the amazing parts of each destination to their fullest.

Scenic Eclipse was inspired by a desire to expand our consciousness, venturing across mighty oceans in search of new experiences most travellers can only dream of. From the balmy Caribbean waters, cosmopolitan cities and dreamscape fjords of Central and South America, to the samurais and geishas that mean so much to a proud Japanese culture, 6-star ocean cruising has never felt better, and your guests are invited to be a part of it. All they have to do is pick which journey of wonder is right for them.



Sea of Cortez marine life

San Blas Islands, Panama



Polar Bears, Svalbard



Ephesus, Turkey



The wildlife of Alaska's Inside passage

Antarctica

Pristine and strikingly beautiful, this region of untouched ice-scapes, mountains rising from the sea, and diverse wildlife will take your breath away.

Antarctica guards its secrets for all but five magical months, when the sea ice slowly retreats and penguins, seabirds, whales and seals make their way south for an intense breeding and feeding season. Purpose built for polar regions, Scenic Eclipse's strengthened hull and Polar Class 6 rating allows safe access to places many others can't. Walk straight on to sea ice from the ship, watch penguin chicks hatch, see the arrival of seal pups and humpbacks – every voyage offers unique experiences.

The Americas & the Caribbean

A vibrant mix of cultures, stunning natural beauty, unique wildlife and glittering cities. Our Discovery Voyages along the diverse coastlines of the Americas will reveal a side to these continents we never knew existed. Witness the pristine wilderness of the Inside Passage as we glide effortlessly through this glacier-lined wonderland. Explore the jungles of Central America on invigorating hikes, marvel at the marine life in the Sea of Cortez and experience island life at its very best in the Caribbean.

The Arctic & Fjords

From the majestic fjords of Norway to Greenland's glaciers and the intriguing geology of Iceland, a voyage to the Arctic is unlike any other. Scenic Eclipse comes into its own in the Arctic – being purpose-built for exploring pristine polar destinations. Imagine soaring over cascading waterfalls of Norwegian fjords in our helicopters*, kayaking between enormous floating icebergs in Svalbard and discovering the Arctic marine-life during a submarine dive* in Greenland. This is simply the best way to explore this vast wilderness.

Europe & The Mediterranean

The azure waters of Europe and the Mediterranean Sea are home to infinite hidden jewels best explored on a Discovery Yacht. Throughout your guests' voyage, they'll dock

right in the heart of historic cities, visiting remote islands and avoiding long drives from commercial ports.

Sail the Mediterranean where the larger ships can't reach, from the small island of Paros, to the bustling city of Barcelona. Explore the seafaring ports of ancient civilisations, being immersed in local traditions old and new.

Polynesia and the Pacific Islands

The islands of French Polynesia offer a delightful blend of Polynesian and French culture. Expect strong cultural heritage, pink-sand beaches, crystal lagoons, spectacular moss-green peaks and two extinct volcanoes.

Indonesia

Indonesia is a melting pot of culture. Located in the 'Caral Triangle', the islands of Raja Ampat and Papua New Guinea are extraordinary.

Japan

Take a discovery voyage through the land where glitzy futuristic cities and ancient well-preserved cultures coexist harmoniously. Ancient samurai traditions, prehistoric archaeological sites, cutting-edge metropolises, and vast swathes of untouched natural scenery. Scenic Eclipse will introduce you to the unseen riches of Japan as only the World's First Discovery Yachts™ can.

*Helicopter and submarine activities at cost, subject to regulatory approval, availability, weight restrictions, medical approval and weather & sea conditions. Helicopter are unable to operate in South Georgia.

35 Scenic Eclipse

Built 2018 | Guests 200/228 | Suites 114 | Crew 182/178 | Length 168 metres | Crew Nationality International | Gross tonnage 17,085 | Speed 17 knots
 Rating Polar Class PC6 | Flag/Port of Registry Malta | Classification society Bureau Veritas

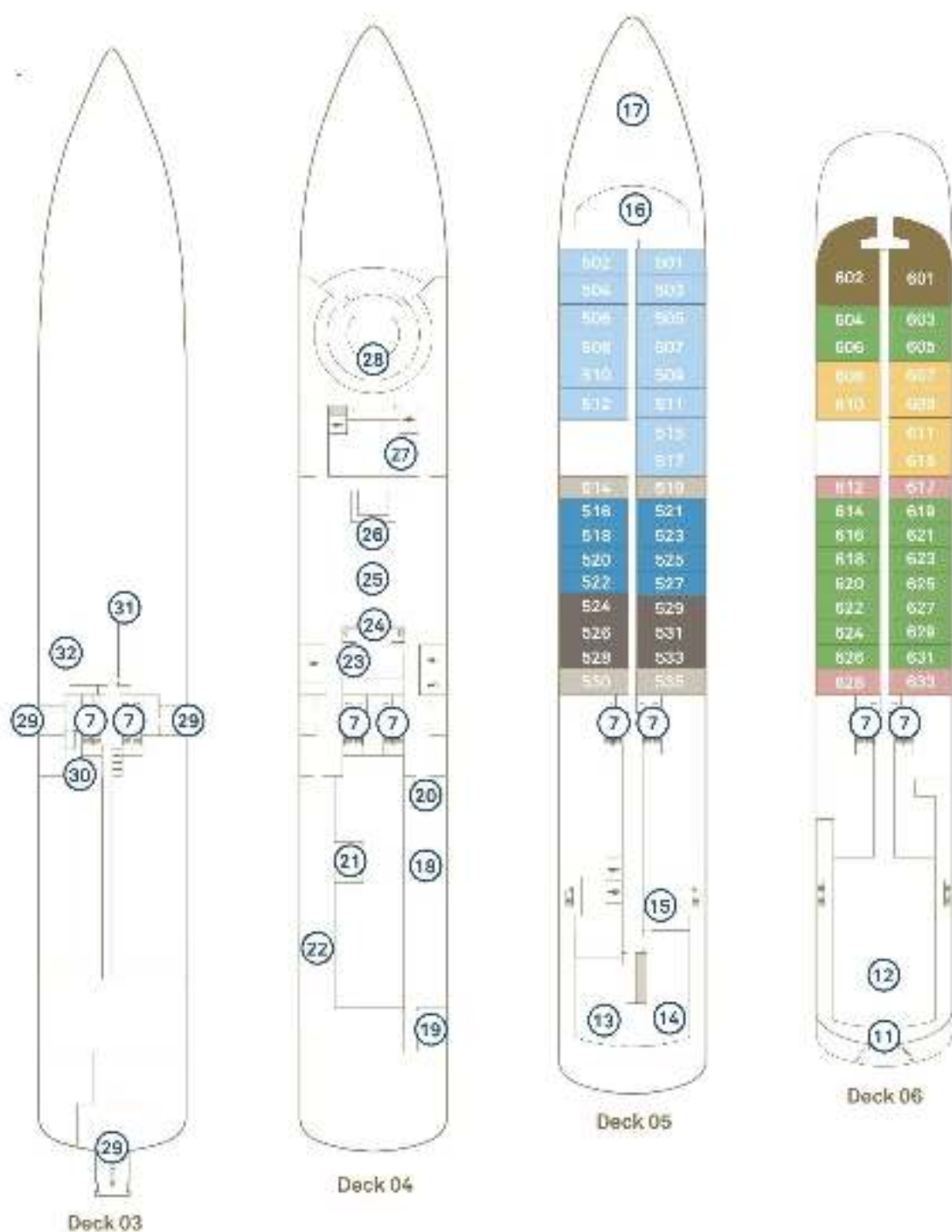

Restaurants	Deck	Passenger capacity
Kava	4, STBD	68
Sushi @ Kava's	4, STBD	18
Night Market @ Kava's	4, STBD	8
Farmhouse	4, PORT	110 + 10 wt Fan
Azure Jar and Cafe	5, STBD	Inside 45 Outside 32
Cha's Table	4, PORT	10
Lumiere	5, PORT	32
Luxure	5, STBD	9-18
Yacht Club	7	Inside 100 Outside 28 Swing Chairs 10

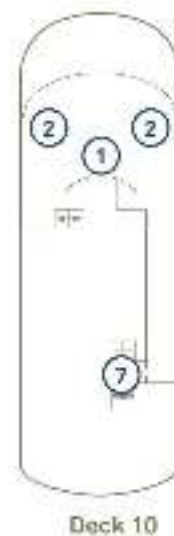
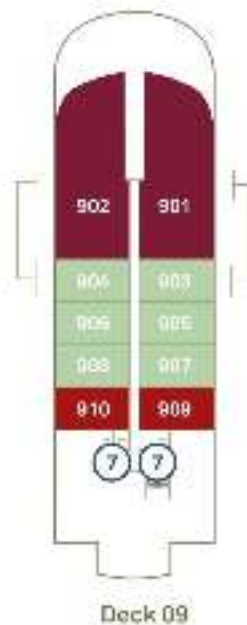
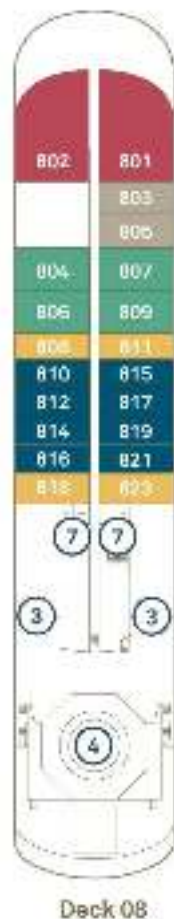
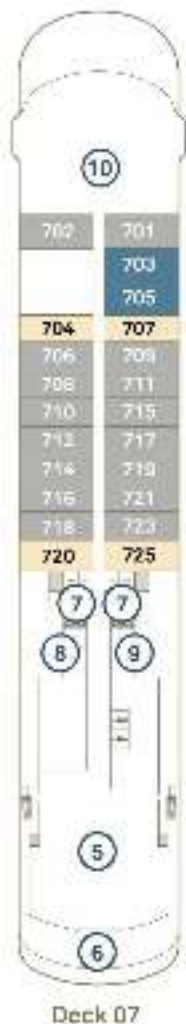
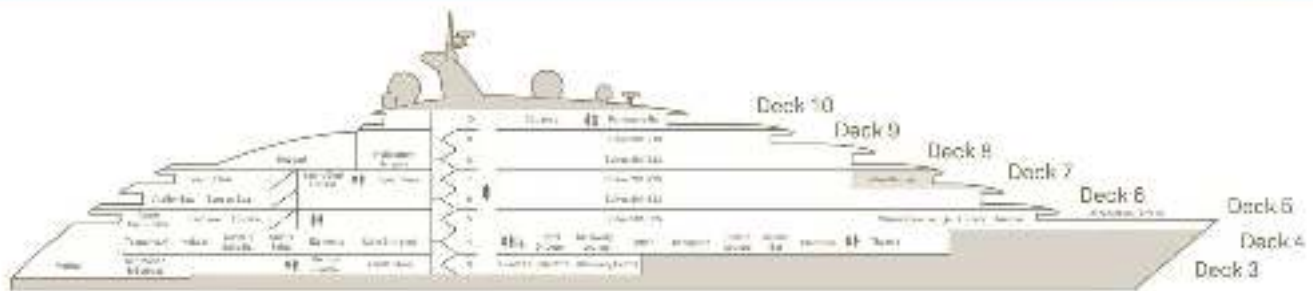

Deck Plan

- ① Panorama Bar
- ② Vitality Pools
- ③ Helicopter hangars
- ④ Helipad
- ⑤ Yacht Club
- ⑥ Yacht Club outdoor dining
- ⑦ Elevator
- ⑧ Yoga & Pilates room
- ⑨ Gym & fitness area
- ⑩ Wheelhouse
- ⑪ Spa Vitality Pool
- ⑫ Sensee Spa
- ⑬ Lumière
- ⑭ Azure Bar & Café
- ⑮ Scenic Epicure
- ⑯ Observation Lounges & Library
- ⑰ Observation Terrace
- ⑱ Koko's
- ⑲ Night Market @ Koko's
- ⑳ Sushi @ Koko's
- ㉑ Chef's Table @ Elements
- ㉒ Elements
- ㉓ Discovery Lounge
- ㉔ Reception
- ㉕ Scenic Lounge
- ㉖ Scenic Bar
- ㉗ Boutique
- ㉘ Theatre
- ㉙ Marina entrance
- ㉚ Medical centre
- ㉛ Self-service guest laundry
- ㉜ Discovery Centre

Suite Categories

Deck 5	Total	Deck 6	Total	Deck 7	Total	Deck 8	Total	Deck 9	Total		
06 Ocean Veranda	24-40m ²	14	07 Grand Panorama	100m ²	2	80 Grand Ocean Veranda	24-40m ²	2	01 Two-bedroom Penthouse	240m ²	1
08 Deluxe Veranda	12-30m ²	11	08 Grand Deluxe Veranda	20-40m ²	4	8A Deluxe Veranda	20-30m ²	14	8A Owner's Penthouse	180m ²	2
04 Deluxe Veranda	10-30m ²	0	0A Deluxe Veranda	10-30m ²	18	B Veranda	30m ²	4	8B Sea Suite	40-50m ²	5
9 Veranda	32m ²	4	C Veranda	32m ²	4	AA Deluxe Veranda	32-50m ²	1	8A Sea Suite	40-50m ²	2
						0AA Veranda	32m ²	4			

*Suites 8A1 & 8A2 and 8A3 & 8A4 consist of two bedrooms - Penthouse Suite. The deck plan and suite layout images are an illustration only and may vary. Suite measurements are approximate, and those in some categories may vary in size.

MEET THE FLEET - EMERALD CRUISES YACHT CRUISING



The Sky Bar

Head to the Sky Bar on the Sky Deck to relax in the Spa Pool as your group enjoy the glorious Mediterranean sun, delicious drink in hand.



The Aqua Pool & Café

At the aft of the yacht on the Pool Deck, guests can take a leisurely dip in between light refreshments, with expansive views of the unfolding panoramas.



La Cucina Terrace

Situated at the back of the La Cucina Dining Restaurant, our large outdoor terrace is the perfect spot for unwinding with company.



Marina Platform

With opportunities for swim stops available, getting in and out of the water couldn't be easier.



Zodiac/ Marina Toys

Venture out on an orientation trip using our on board Zodiacs or take our marina toys out on the water, including snorkelling equipment, a trampoline and paddleboards.



Observation Deck

The prime position for photographs as wonderful views continue to present themselves as we sail in and out of beautiful ports.



Observation Lounge

Enjoy unrivalled sea views in comfort, looking out for marine life and approaching land. Or, simply relax with a selection of premium drinks.



Amici Lounge

Meet new-found friends or members of your group for great conversation in stylish surrounds, as our bar staff serve a selection of premium drinks.



La Cucina Dining Restaurant

Fine dining from an à la carte menu, as well as a breakfast and lunch in a stylish setting, with tables designed for couples and groups.



Wellness Area

Guests can treat themselves to a spa treatment*, book a hair appointment*, relax in the sauna or work out in our well-equipped gym.

*Available at additional cost.





— THE SUPERYACHT EXPERIENCE - EMERALD CRUISES

Introducing Emerald Azzura and Emerald Sakara, the latest additions to our award-winning fleet and our first luxury superyachts.

Designed to navigate the stunning coastlines of the Mediterranean, the Adriatic Sea, the Red Sea & Middle East, the Black Sea and the Indian Ocean, an intimate guest capacity and an abundance of space across six spectacular decks affords true opulence from the minute your guests step on board.

Reaching an impressive 110 metres in length, our spectacular new superyacht will exceed your guests' yacht cruising expectations. An abundance of space on board, combined with a guest number of 100 and a crew of 64, allows us to provide an excellent level of personal service throughout their trip.



Elements Spa



YACHT CRUISING —



Private outdoor balcony



Well-equipped gym

Dine

Fine à la carte dining and sumptuous breakfast and lunches in the serene setting of our spacious La Cucina Dining Restaurant, take inspiration from the path we're navigating. Your guests can expect fresh, locally sourced dinners, thoughtfully crafted by our expert chefs, with complimentary sommelier-paired wine, beer or soft drinks with lunch and dinner. And, in the evening, once guests have enjoyed their meal, they can head to the back of the restaurant to appreciate the ocean breeze from our large al fresco La Cucina Dining Terrace, before a nightcap in the plush, relaxed location of Amici Lounge.

Unwind

Guests can unwind completely in our on board Wellness Area, where a selection of indulgent spa treatments include massages, facials and even a hairdresser*. We've introduced a well-equipped gym for those who like to keep up with their fitness regime, as well as a fitness guide who will hold a variety of classes to encourage them to stretch their legs and find their centre during their time on the water.

With a plethora of marine life inhabiting our vast oceans, guests will have the opportunity to make use of our special marine platform, where they can board our Zodiac for expert-led excursions, venturing off in search of the water's native inhabitants. In selected ports, we'll also have a number of marine toys to jump in and play with.

*Spa treatments and hairdressers at additional cost.

Please note our Emerald Cruises itinerary is currently being built. Emerald Azores is due for completion in December 2024 Emerald Salinas is due for completion in 2025, all images are virtual mock-ups. On board facilities are shown as shown in the time of print (2024) but are subject to change.

Retreat

We've uniquely designed every one of our suites and staterooms to become your guests' own private haven, where everything they need will be at their fingertips. They'll relax in their spacious, modern surrounds, enjoying a collection of luxurious amenities. 60% of cabins on board have a private balcony so guests can enjoy unparalleled views as they sail into some of the most picturesque ports and harbours on Earth.



Yacht Suite

So much is included

...on our yacht cruises

- Airport transfers to and from your yacht.
- Breakfast, lunch and dinner on board.
- Complimentary wine, beer and soft drinks to accompany lunch and dinner.
- State-of-the-art coffee machines and tea stations.
- Complimentary water, refreshed daily.
- First-class service from an English speaking crew.
- Included excursions with knowledgeable local guides.
- Complimentary Wi-Fi on board.
- All airport taxes and port charges.
- The opportunity to customise to your needs.
- ABTA & ATOL protected.
- PLUS all gratuities on board are taken care of



— ON BOARD INCLUSIONS - EMERALD CRUISES YACHT

Exceptional EmeraldVALUE

The Emerald Cruises promise of exceptional EmeraldVALUE reassures your group that everything they need is included in the price. Unlike many other cruise lines, all transfers and tips are included in the price they pay, as well as a selection of dining options, complimentary drinks with lunch and dinner, and insightful excursions. All they have to think about is enjoying their cruise.

Guests will be transported to the heart of local life during wonderful days ashore, before returning to their superyacht for regionally inspired meals, with complimentary wine, beer or soft drinks. On board, Emerald Cruises have included all the delightful finishing touches you'd expect from a world-class hotel. Sumptuous toiletries, a flat-screen TV and infotainment system and Wi-Fi in every suite will help them to settle in. And a selection of thoughtfully designed spacious public areas are perfect for catching up with friends over a drink or unwinding after an exhilarating day.



Owner's Suite, Emerald Azzura



La Cucina Terrace



Observation Lounge

CRUISING –

A sanctuary of serenity for your guests

We've uniquely designed every one of our suites and staterooms to become your guests' own private haven, with 88% featuring their own private balcony or terrace. Unlike anything currently available, they will be invited to relax in their spacious, modern surrounds, enjoying a collection of luxurious amenities, as we sail into some of the most picturesque ports and harbours of Harb.

All suites and staterooms include:

- Queen-size or twin hotel-style beds with the finest, Egyptian cotton linen
- En-suite bathroom with luxurious toiletries
- Complimentary bathrobes and slippers
- Flat screen HDTV and entertainment system
- Complimentary water, restocked daily
- Complimentary Wi-Fi
- Individual climate control
- Mini-bar
- Personal safe
- Umbrella
- Telephone

And selected suites and staterooms include:

Oceanview Stateroom

- An ocean-view window
- Excellent location at the front of the yacht

Balcony Stateroom

- Your own private outdoor balcony
- Located across two decks

Terrace Suite

- Your own private terrace
- Pillow menu
- Welcome bottle of champagne
- Fruit platter on arrival
- Full mini-bar, restocked daily
- Coffee and tea-making facilities
- Two items laundered daily

Yacht Suite

- Your own private terrace
- Walk-in wardrobe
- Pillow menu
- Welcome bottle of champagne
- Fruit platter on arrival
- Full mini-bar, restocked daily
- Coffee and tea-making facilities
- Two items laundered daily

Deluxe Balcony Suite

- Your own private outdoor balcony
- Separate bedroom and lounge area
- Pillow menu
- Fruit platter on arrival
- Coffee and tea-making facilities
- Excellent location on the Pool Deck

Owner's Suite

- Your own private terrace
- Separate bedroom and lounge area
- Walk-in wardrobe
- Pillow menu
- Welcome bottle of champagne
- Fruit platter on arrival
- Pre-dinner canapés
- After-dinner sweets
- Full mini-bar, restocked daily
- Coffee and tea-making facilities
- Four items laundered daily



La Cucina Dining Restaurant



— THE ON SHORE EXPERIENCE - EMERALD CRUISES YACHTS

With so much beauty to uncover on each cruise, we've made sure guests will see the very best of every location we visit.

Adventure abounds on our included excursions, while free time encourages the explorers of the group to head off the beaten track. We want guests to feel free to personalise their time onshore, with plenty of opportunity to disembark for unguided city visits and evenings out. Of course, our cruise directors will always be available for advice and inspiration on a destination's hotspots.



Explore spectacular locations



Included Excursions

Each of our wonderful itineraries includes a selection of included excursions, handpicked by our journey planners to offer insightful and diverse experiences.

Groups will embark on guided tours of Ancient Greek landmarks and walking tours of cities and towns including tastings of local delicacies. They'll walk the golden beaches of Egypt and the historic battlefields of Turkey.



Greek temple, Acropolis, Athens, Greece

YACHT CRUISING



Sample local delicacies



Discover hidden gems

 EmeraldPLUS

Our extra-special EmeraldPLUS excursions and experiences aim to take your guests to the heart of local culture, customs and traditions. Sure to be a highlight of their trip, they'll enjoy a mussel cooking demonstration and tasting in the Albanian city of Sarandë and a walking tour of Naples with time to stop at a 19th century coffee house. They'll witness the magnitude of the Great Pyramids of Giza and embark on a Felucca cruise on the Nile.

 EmeraldACTIVE

Specially designed for guests seeking more active experiences, and an exciting way to see a destination, our EmeraldACTIVE excursions allow guests to see places from a different perspective.

Group cycling tours make for exhilarating explorations of ancient fortifications and cities, while guided hikes reveal spectacular views of a destination. Climb to the top of Marjan Hill, for outstanding panoramas of the Adriatic Sea as it hugs the shores of the Croatian city of Split, or to the Monastery of St. John and the Cave of the Apocalypse in Patmos.

 DiscoverMORE

Available at an additional cost for guests who wish to see and do even more, these immersive experiences and excursions enable you to dive further into an area's history and culture. Try out a kayak or rafting experience on the Croatian Zrmanja River, visit the Island of Our Lady of Rocks off the coast of Koror, or immerse yourself in the Turkish culture during a Turkish bath experience or tour of Topkapı Palace.



Naples, Italy



Cave of the Apocalypse, Patmos, Greece



Discover history and culture

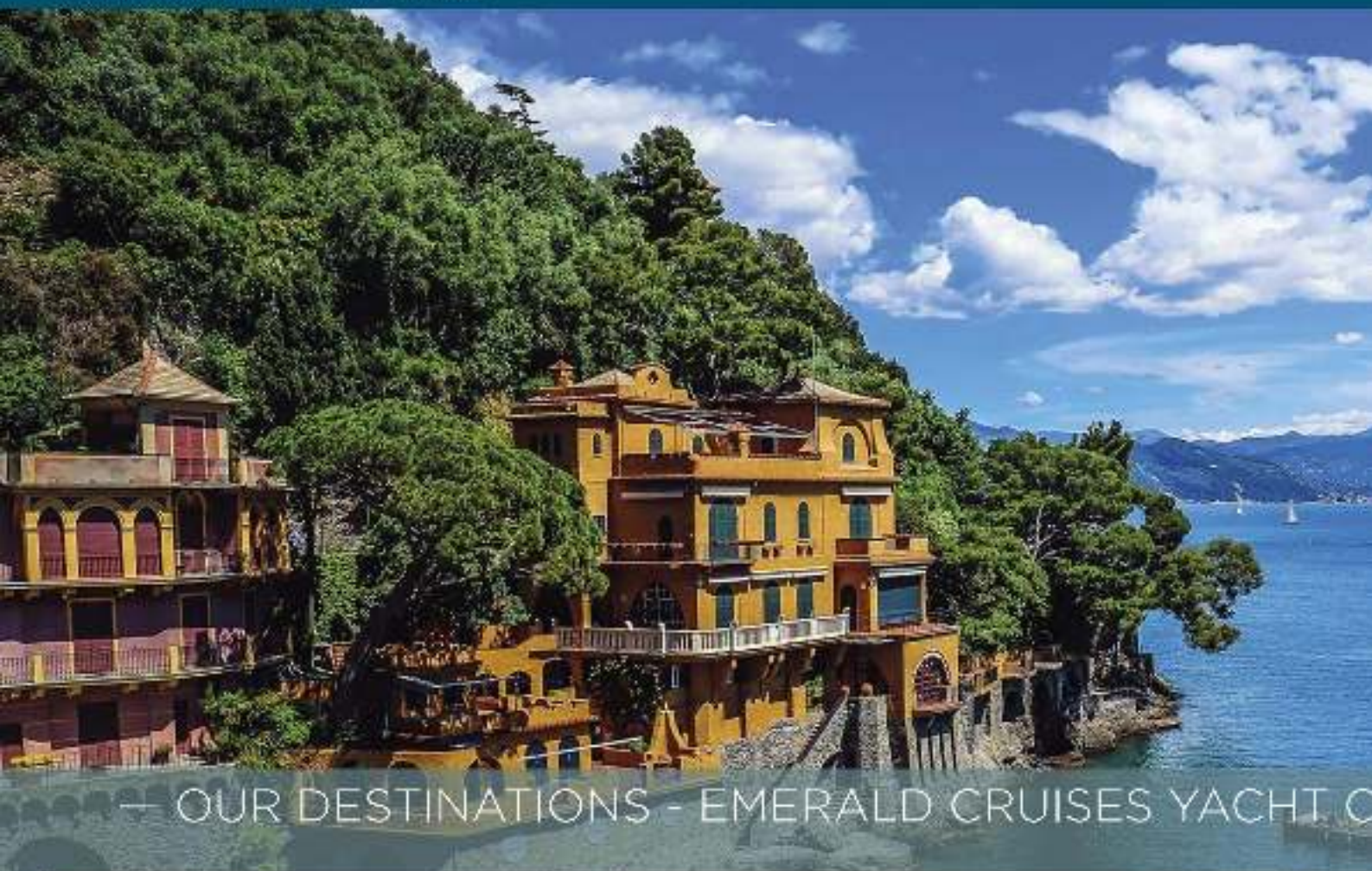

— OUR DESTINATIONS - EMERALD CRUISES YACHT C

Where we sail

Let us take you on a journey, off the beaten track and along timeless trade routes, on board our bespoke luxury superyachts.

Discover some of the oldest communities to have ever existed, explore the crystalline waters connecting stunning island groups, visit six fascinating countries all at once, and even uncover the mysteries of the Holy Land.

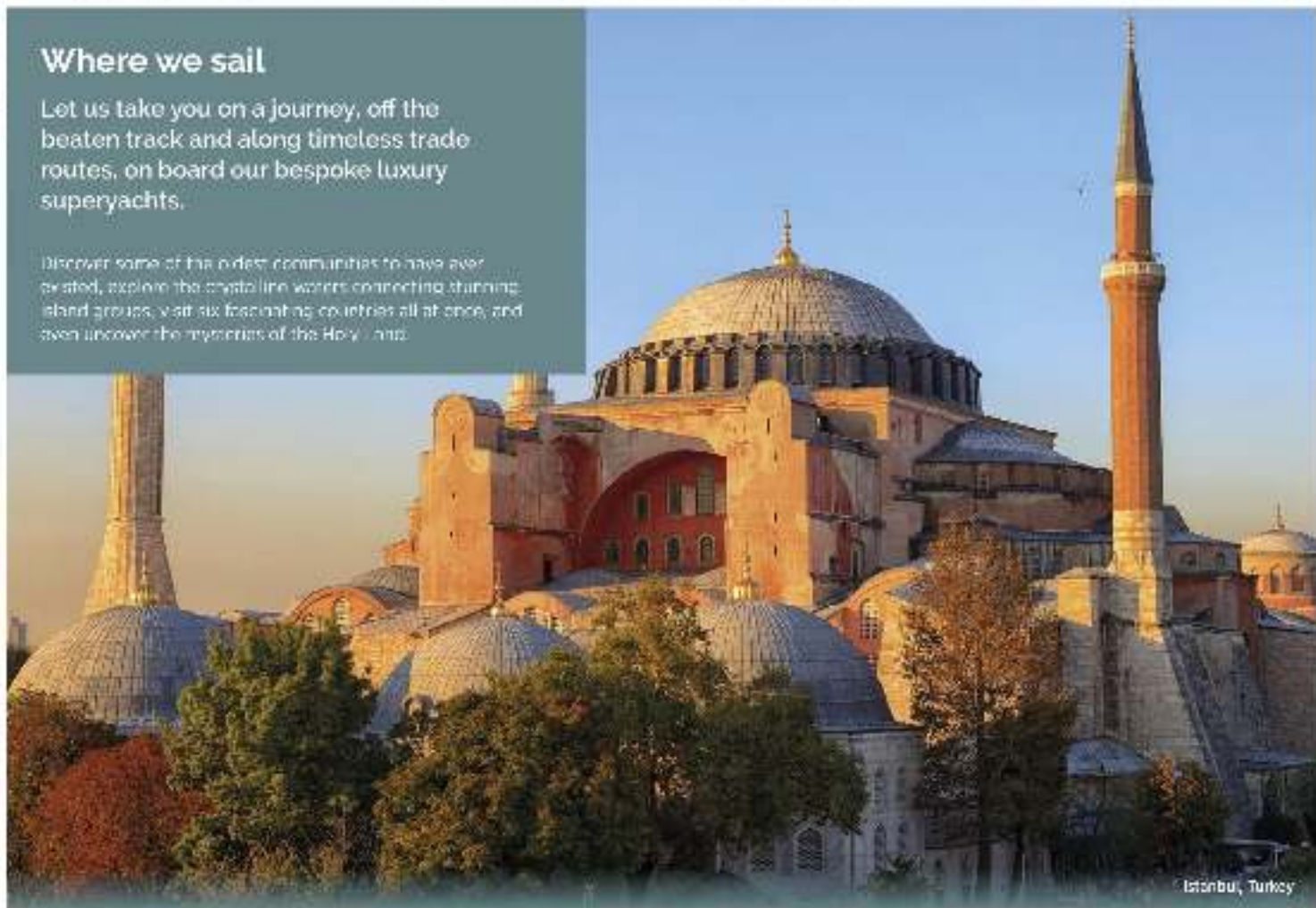

Istanbul, Turkey



CRUISING -



Santorini, Greece



Capri Island, Greece

The Adriatic Coast

The waters of the Adriatic Sea provide access to some of Europe's most exciting ports. Separating the Italian and Balkan peninsulas, it contains 1,300 islands belonging to Albania, Bosnia & Herzegovina, Croatia, Italy, Montenegro and Slovenia.

The Eastern Mediterranean

One of humanity's most important crossroads and now a route offering such variety of ports, the Eastern Mediterranean is a route paved with historic monuments and paradise-like island groups, where the past is celebrated in the present.

The Western Mediterranean

Covering the continents of Europe and Africa, the Western Mediterranean promises effuring culture, rich history and mouth-watering cuisine. From the French Riviera, to the southern Italian coast via the Island of Sicily.

The Red Sea

A global 200 ecoregion, the Red Sea is an inlet of the Indian Ocean, located between Africa and Asia. Having played a crucial navigational role since ancient times, its coastline is now a popular tourist attraction where nature and archaeological monuments feature in abundance.

The Black Sea

Situated between Europe and Asia, the fascinating Black Sea is surrounded by Turkey, Russia, Bulgaria, Romania, Georgia and the Ukraine. Embrace the spirit of countries with vast tales to tell, explore historic battlefields and walk golden beaches. Watch as Middle Eastern and Western European cultures collide in spectacular fashion.

The Indian Ocean

Warm, vast and crystal-clear, the Indian Ocean is the world's third largest ocean. Explore the Seychelles archipelago on board an Emerald Cruises luxury superyacht, hopping from one fascinating destination to the next. A true desert island paradise, with sandy beaches, dense rainforest, and a plethora of spectacular wildlife reveals each island's own charming personality.



Hurgada, Red Sea, Egypt



Bodrum, Turkey

Emerald Azzurra & Emerald Sakara - The Adriatic Coast, The Red Sea, The Mediterranean, The Black Sea

Built 2021 | Length 360,9H (119 metres) | Guests 100 | Cabins 50 | Crew 68 | Crew Nationality International | Gross register tonnage 5175,5 | Speed 12 Knots
 Flag / Port of Registry: Nassau, Bahamas | Classification society: Croatian Register of Shipping (IACS member)

DECK 7 SKY DECK
 DECK 6 POOL DECK
 DECK 5 PANORAMA DECK
 DECK 4 OBSERVATION DECK
 DECK 3 EMERALD DECK
 DECK 2 WELNESS DECK

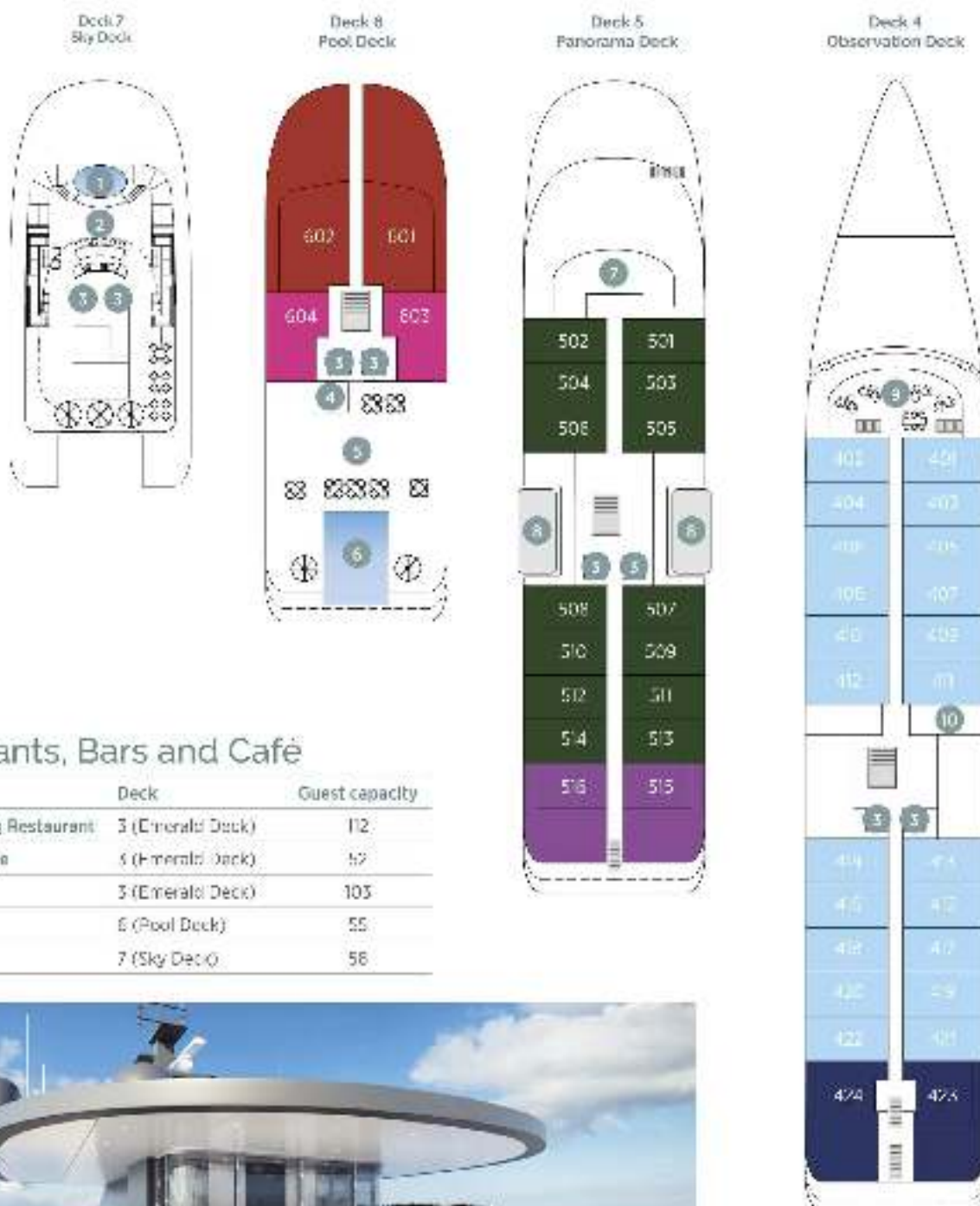
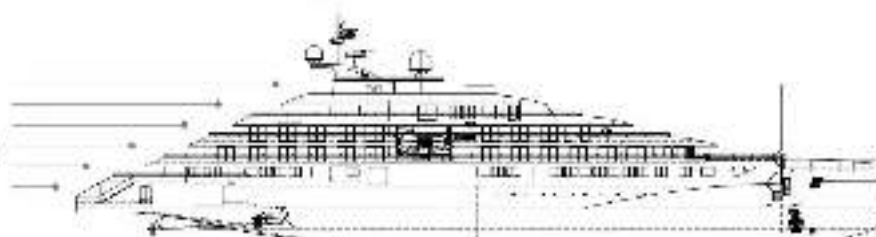

Restaurants, Bars and Café

	Deck	Guest capacity
La Cucina Dining Restaurant	3 (Emerald Deck)	112
La Cucina Terrace	3 (Emerald Deck)	52
Amiki Lounge	3 (Emerald Deck)	103
Pool Café	6 (Pool Deck)	55
Sky Bar	7 (Sky Deck)	56



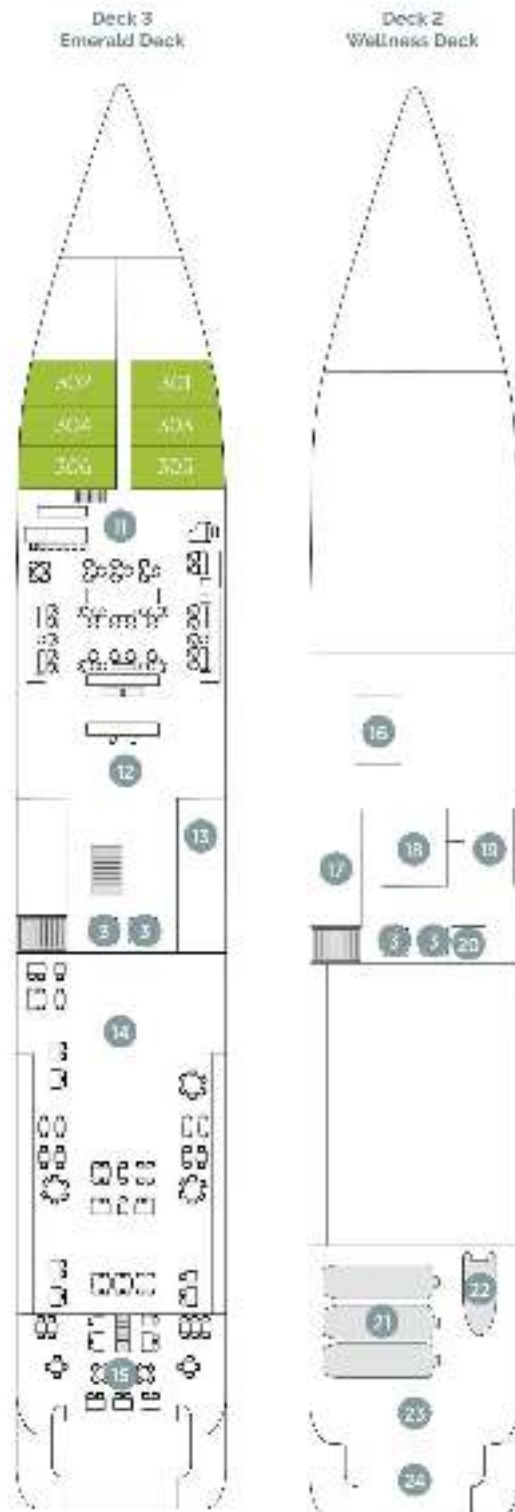

- ① Spa Pool
- ② Sky Bar
- ③ Lifts
- ④ Pool Cafe
- ⑤ Pool Lounge Area
- ⑥ Aqua Park
- ⑦ Navigation Bridge
- ⑧ Life Raft
- ⑨ Observation Lounge
- ⑩ Guest Laundry
- ⑪ Amic Lounge
- ⑫ Reception
- ⑬ Shop
- ⑭ La Cucina Dining Restaurant
- ⑮ La Cucina Terrace
- ⑯ Medical Centre
- ⑰ Gym
- ⑱ Salon
- ⑳ Spa
- ㉑ Hairdressers
- ㉒ Tender Deck
- ㉓ Zodiac
- ㉔ Storage
- ㉕ Marina Platform

Cabin Categories

Pool Deck	Size (l' x w')	Total
SA Ocean Suite	104.00' x 102.00'	2
S Double Deluxe Suite	51.50' x 30.00'	17
Panorama Deck		
T Terrace Suite	90.00' x 62.00'	2
A Balcony Suite	35.50' x 28.00'	14
Observation Deck		
V Yacht Suite	63.00' x 37.00'	2
B Balcony Suite	25.50' x 28.00'	12
Emerald Deck		
B Oceanview Stateroom	17.00' x 19.00'	16

Important Information: Deck plans are an indication only and are subject to variation. Cabin sizes include terrace areas.

THE SCENIC GROUP

SCENIC[®]

LUXURY CRUISES & TOURS



EMERALD CRUISES



For more information contact our Group and Charters Team on charters@scenic.eu
Visit scenic.eu/charter | Visit emeraldcruses.eu/charter